



Performing Arts  
Division -  
Technical Support  
Unit

**Kwai Tsing Theatre**

12 Hing Ning Road  
Kwai Chung,  
NT, HK  
Phone  
852-2408 0128  
Fax  
852-2944 8743

**CONTACTS**

**Sharon CHOW**

Senior Manager (NTS)  
Venue  
Direct Line  
852-2408 0660

**Rei WONG**

Manager (KTT)  
Operations  
Direct Line  
852- 2408 2115  
Email  
rhwong@lcsd.gov.hk

**Eric CHAN**

Resident Technical  
Manager (NTS)  
Direct Line  
852-2406 2848  
Email  
eytchan@lcsd.gov.hk

**GENERAL SET-UP**

*Kwai Tsing Theatre operates on a 'bare-walls' touring policy. That is, all equipment is normally set-up and struck within the booking period. Hirers are reminded to allow sufficient preparation time to hang theatre masking, rig all overhead stage lighting and set up sound. Check with our Resident Technical Manager for any other equipment and technical enquiry.*

# Kwai Tsing Theatre - Auditorium

## FULL Technical Information

V. 2023.10.03

Page 1 of 8



Kwai Tsing Theatre is a traditional proscenium theatre designed and fully equipped to stage major Drama, Dance and Musicals. It can be used for large-scale Opera, Chinese Opera and Variety performances. In addition, the stage can be used for acoustic shell layout.

**DIRECTIONS**

**MTR:**

Tsuen Wan Line, Kwai Fong Station, Exit C

**Driving Route (From S to N):**

Route 3 → Exit 4B → Hing Fong Road → Kwai Fuk Road → Hing Ning Road

**Driving Route (From NW to S):**

Route 3 → Exit 10 → Hing Fong Road → Kwai Fuk Road → Kwai Yan Road → Hing Ning Road



**LOADING**

Clearance of truck: 4.30m

Dock Height: 0.9m

Shutter Opening:

7.90 x 4.50m (W x H)

Shutter Opening to side stage:

4.00 x 9.50m (W x H)

Shutter Opening to rear stage:

1.96 x 9.63m (W x H)

Vehicle longer than 11m requires special arrangement with the Venue Management.

**STAGE ENTRANCE**

From Venue Foyer next to the Box Office.

**PARKING**

Permit required



Note: Except for buses and those with permits issued by the Commissioner for Transport, vehicles exceeding 11 metres are not allowed into Hing Ning Road.

[https://www.td.gov.hk/en/traffic\\_notices/index\\_id\\_22410.html](https://www.td.gov.hk/en/traffic_notices/index_id_22410.html)



**AUDITORIUM**



**Total Seating: 899**

Stalls: 625

Balcony: 274

**Removable Seating**

Pit Lift (seats): 66

8 seats will be lost from the end of Row B & C at Stalls Level for setting black railing staircases.

3, 6 or 10 seats from the centre of Row R at Stalls Level can be dismantled for video recording or setting up control panel.

**PROSCENIUM**

Structural Opening	17.00 x 10.50m (W x H)
Adjustable opening width (by portals)	12.00 - 15.00m
Adjustable opening height (by house border)	7.50 - 9.00m

**STAGE WIDTH**

Centreline to stage right fly floors	11.65m
Centreline to stage left fly floors	11.28m
Centreline to stage right wall	32.80m
Centreline to stage left wall	31.67m

**STAGE DEPTH**

Rear of Proscenium to rear-stage shutter	18.10m
Rear of Proscenium to stage edge on CL	2.54m
Stage front to rear stage wall	33.30m
Stage front to rear stage shutter	18.40m

**STAGE HEIGHT**

Clearance under fly floors	9.11m
Clearance under grid	23.72m
Maximum bar flying height	20.94m
Above Auditorium	0.95m

**FORESTAGE / ORCHESTRA PIT**

Curved forestage / pit lift area	60.00m <sup>2</sup> (gross)
Depth on CL	4.60m
Height to audience level	2.55m
Pit setup provision with chairs, stools, music stands, conductor platform and music lights	
Capacity	5,000kg SWL

**STAGE FLOOR**

Flat black surface hardboard	500kg/m <sup>2</sup> SWL
Trap - DSC, DSR and DSL	3.00 x 6.40m each
Compensating elevators for sinking wagon or sprung floor flushed with surrounding stage area	17.00 x 13.50m (W x D)
Dip traps SR & SL of CL full depth of stage	11.28m
Surround track with side masking	



**SIDE STAGE**

Opening SL	14.15 x 9.00m (W x H)
Opening SR	13.60 x 9.00m (W x H)
Side stage area SL (Lighting equipment stored at USL)	10.00 x 15.00m
Side stage area SR (with acoustic shell stored at USR)	8.79 x 13.52m

**The side stage right fire shutter is treated as a safety curtain by FSD and cannot be obstructed by scenery, equipment or stage wagon in production.**

**REAR STAGE**

Opening	17.50 x 9.00m (W x H)
Depth	14.50m
Surround track with wrap-around black masking	
Stage wagon	17.00 x 13.54m (W x D)
(Preset at rear stage)	0.49m (H)
Revolve centered on wagon	13.00m (Dia)
Revolve Dynamic Capacity	10,000kg SWL
Wagon Dynamic Capacity	15,000kg SWL
Static or dynamic local load	500 kg/m <sup>2</sup> SWL

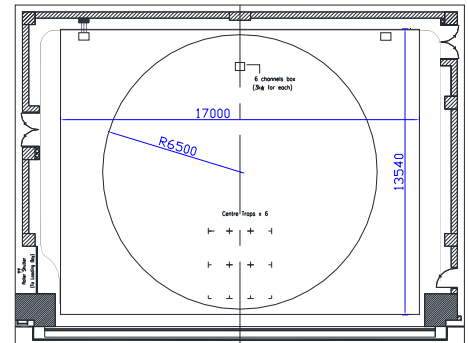

**The rear stage fire shutter is treated as a safety curtain by FSD and cannot be obstructed by scenery, equipment or stage wagon in production.**

**STORAGE SPACE**

Between side & rear stage:	50.00m <sup>2</sup> x 10m (H)
----------------------------	-------------------------------

**CROSSOVER**

Rear of stage

**RIGGING**

**House Curtain** (Burgundy) motor fly or draw Variable speed electric

**Stage Lighting Bridge** (from 7.5m to 9m) Fixed speed electric  
Light Bridge under bar capacity 200kg SWL

**Rigging System**

SBS - COSTACOWin<sup>®</sup> V5: Computerised flying bars 63  
*Prior submission of fly cue plot will speed up the production process. Fly cues updates require additional time for computer input.*  
*The system is able to fly 12 bars simultaneously.*

Bar diameter 48mm

Bar distance  
*Refer to hanging plot for location and availability*

Bar length (Bar 5 - 70) 18.50m extendable to 20.00m if side bars are not being used

Bar 1 16.50m  
Capacity 650kg SWL

Pinrail 21m  
Height from stage floor



Side Bar	6 (3 on each side)
Bar 101 & 106 hung with 4 tiers of lighting ladder	
Bar length	12.00m
Capacity	650kg SWL
Point Hoist	
Fixed speed electric	5
Capacity	325kg SWL
Rear Stage Bar	3
Bar length	16.00m
Capacity	500kg SWL

**STAGE EQUIPMENT**

**Stage Drapery**

Black Masking	Legs	12	flat	4.50 x 11.00m	General rig
	Borders	5	flat	20.00 x 5.00m	General rig
	Black backdrops	2	flat	20.00 x 11.00m	General rig
	Side masking leg	14	flat	2.50 x 10.60m	General rig
Spare Black Masking	Legs	2	flat	4.50 x 11.00m	
	Borders	2	flat	20.00 x 5.00m	
Cyclorama		2	flat	20.00 x 11.00m	General rig
Black Gauze		2		20.00 x 11.00m	
White Gauze		2		20.00 x 11.00m	

**CONCERT LAYOUT (with ACOUSTIC SHELL)**

Stage width	15.13m
Stage depth	9.61m

**Orchestra Riser**

Wenger Trouper. Metal frame platform.  
Chair rails available. No drilling or painting.

2.4 x 1.2m (W x L)	203mm (H) x 4
	407mm (H) x 4
	610mm (H) x 4

**Choir Riser** (3 or 4 steps) Wenger Tourmaster  
7 sets for 120 persons

**Musician Chair** 80

**Music Stand** 100

**Dancing Tile** Black / grey reversible for main stage  
*for dance show only* (Please allow time for laying the tiles during booking time)

**Sprung Dance Floor** Sinks flush the stage 17.00 x 13.50m (W x D)  
*for dance show only* on wagon  
(Please allow time for laying the floor during booking time)

<b>Stage Carpet</b>	Red	2	17.00 x 7.50m
<i>for Chinese Opera only</i>	Green	2	15.00 x 7.50m

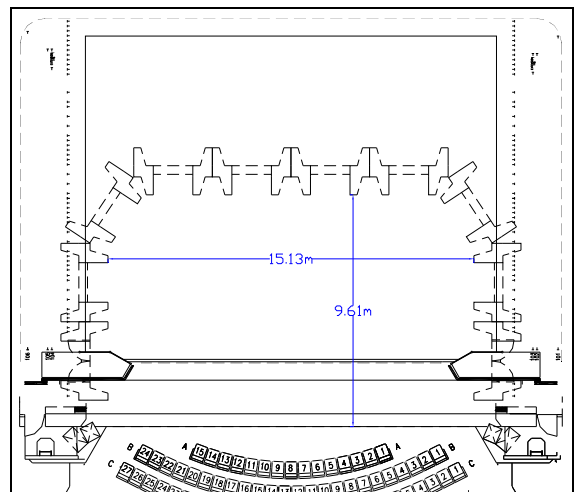



<b>Instrument</b>	Concert Grand Piano	2	Steinway & Sons Model D ( <i>incur extra charge</i> )
	Baby Grand Piano	1	Yamaha C1
	Upright Piano	1	Yamaha U1
	Timpani	1 set (4 pcs)	Yamaha (23", 26", 29", 32")

**Lift and Ladder**

Hydraulic Lifting Platform Genie 30S DC	2	<i>On-site training and prior approved by venue management only</i>
--	---	---

Braces & weight Available as requested

**DRESSING ROOM**

G/F Hirer's Office with local phone, and broadband internet.  
**No. 1 - 3:** each accommodate 1 person  
**No. 4 - 5:** each accommodate 20 persons  
**No. 6 - 7:** each accommodate 5 persons

B/F **No.8 - 9:** each accommodate 30 persons  
**No.10 - 11:** each accommodate 1 person



*All dressing rooms fitted with private toilet and shower*  
Quick change facilities can be temporarily arranged when required.

2 washing machines, 2 dryers, located at dressing room No.7.  
*Sewing machines , irons & boards and steamers can be loaned from Stage Management Section.*

**LIGHTING**

**Dimmer** ETC Sensor3 dimmer system. A total of 372 dimmers. 328 nos. of 3kW; 44 nos. of 5kW.

**Control Board** ETC - Gio, with full backup control facilities, controllable of maximum 4,096 parameters, located in Lighting Control Room at rear of Balcony.

**House Light** Dimmer controlled. Take-control available in Lighting Control Room.

**Circuit** 328 x 3kW and 44 x 5kW production lighting circuits, fixed wiring type, 3kW and 6kW circuits are terminated to 15A and 32A socket single phase outlets to UK standard respectively on the production lighting boxes, distributed at various locations throughout the Stage and lighting bridges (including 6 x 3kw on revolve).

**Additional Power** 220 Volt single phase or 380 Volt; 3-phase/4 wire, max. 400A/phase, located at US Right rear wall c/w 400A clamping busbar for temporary cable connection.

***Connection must be conducted by a local registered electrical worker.***

***Hirer shall supply adequate circuit protective devices for all bring in electrical installation.***

***13A wall-mounted socket outlets at UK standard are provided on the stage.***

**Front of House Position** Lighting Bridge 1, 12.00m throw at 81 degree  
Lighting Bridge 2, 14.00m throw at 60 degree  
Circle Rail, 12.00m throw at 30 degree  
Rear Rail, 20.00m throw at 37 degree



<b>Profile</b>	750W	ETC	Source 4 25/50°	40	
	750W	ETC	Source 4 15/30°	110	
	305W	ETC	Source 4 LED Series 3 Lustr 15/30°	12	
<b>Fresnel</b>	5.0kW	Strand	Pollux F	3	
	2.0kW	Strand	Alto F	76	
	1kW	Robert Juliet	310 H Fresnel	24	
<b>LED Automated Lighting</b>	750W	Robe	T1 Profile	16	
	820W	Vari-Lite	VL2600 WASH	16	
<b>LED Automated Lighting requires time for rigging and address setting. It will be provided only for productions with 6 sessions or more. Hirers shall supply their programmer for the equipment's programming and operation.</b>					
<b>PAR</b>	1kW	Strand	PAR 64	70	CP60, CP61 & CP62 lamps, 60 pcs each available
<b>Beamlight</b>	500W	Strand	BeamLite 500	3	2.4kW Dimmer 'DynaLite'
	1.0kW	Strand	BeamLite 1000	3	
<b>Cyclorama Light</b>	200W	Altman	Spectra RGBA	8	
<b>Ground Row</b>	200W	Altman	Spectra RGBA	8	
<b>Followspot</b>	2.5kW	Robert Juliet	Cyrano 1015	2	
<b>Effects Projection</b>	2.5kW	Strand	Toccata EP, VAFX 90	2	Optical effect moving drive
	Effects		Fleecy clouds	2	
			Storm clouds	2	
			Rain	2	
			Snow	2	
			Flame	2	
<b>Smoke / Haze Generator</b>		Look Solutions	Viper NT DMX controllable	2	
		Look Solutions	Unique 2.1 DMX controllable	2	
<b>Strobe Light</b>		Martin	Atomic 3000 LED DMX controllable	2	
<b>UV light</b>		Wildfire	WF-402	3	
<b>Others</b>	Side light tower			10 + 2 (no pre-rigged)	
	Tower equipment setup:	5 (top)	ETC Source 4 15/30°	1900mm*	
		4	ETC Source 4 15/30°	1470mm*	
		3	ETC Source 4 15/30°	1050mm*	
		2	ETC Source 4 15/30°	610mm*	
		1 (bottom)	ETC Source 4 15/30°	220mm*	
<b>* = Height the equipment from the centre of lens to the floor</b>					
Side light ladder			Hung on side bar 101 and 106 (an average SWL for each ladder is 65Kg)	8	
LED Music stand light				80	



<b>Iris &amp; Gobo Holder Spotlight Applicable</b>	<u>Iris</u> <u>Qty.</u>	<u>Holder</u> <u>Qty.</u>	<u>Holder</u> <u>Type</u>	<u>Gobo</u> <u>Size</u>	<u>Image</u> <u>Size</u>
ETC Source 4	20	30/19	A/B	100/86mm	68-75mm /65mm

Supply of above equipment subject to availability on receipt of a lighting plan.

Equipment availability does vary slightly according to equipment conditions and maintenance. Check with Resident Technical Manager for any updates.

**Hirer will be provided with basic lighting only, from available hung equipment, if technical preparation time is less than 2 hours in the booking.**

All brought-in “Electrical and Stage Lighting Equipment” to be used in LCSD PA venues, shall meet the requirements of “Code of Practice for Electricity (Wiring) Regulations (2020 Edition)”. Please contact the venue management for any electrical safety concern. Website reference:

[https://www.emsd.gov.hk/en/electricity\\_safety/index.html](https://www.emsd.gov.hk/en/electricity_safety/index.html)

**SOUND**

<b>Sound System</b>	L-Acoustics Scene System KARAI (5 Line-Array)	40
	L-Acoustics X8 Coaxial Speaker (Fill System left & right)	4
	L-Acoustics KS21 Subwoofer	6
	L-Acoustics 5XT (Front-Fill loudspeaker)	6
	L-Acoustics X8 Coaxial Speaker (Surround Speaker located at the side and back of Stall)	9
	L-Acoustics X8 Coaxial Speaker (Surround Speaker located at the side and back of Balcony)	7
	L-Acoustics L-ISA Multichannel Audio Processor	1 set
<b>Main Control Console</b>	DiGiCo SD7 Quantum	
	Mono inputs	32
	Stereo inputs	12
	Aux outputs	16
	Group outputs	16
	Matrix outputs	16
<b>Additional Control Console</b>	DiGiCo SD10 digital mixing console	
	Mono inputs	48
	Mono outputs	24
<b>Microphone tie line</b>	Each side of the stage	32
	at orchestra pit	32
	at rear of stalls	32
<b>Signal Processor</b>	Lexicon 300L Effect System	1
	Lexicon PCM92 Digital Effects Processor	1
	T.C. Electronic M-3000 Digital Multi-Effect Processor	1
	T.C. Electronic Finalizer 96K	1
<b>Microphone</b>	AKG C414B	4
	Crown PCC 160	5
	DPA d:vote 4099	8
	Neumann KM183mt	2
	Neumann KM184	8
	Neumann KM185	4
	Neumann KMS105	4
	Neumann TLM-103mt	2
	Shure Beta 52	1
	Shure Beta 56	1
Shure Beta 57A	4	



	Shure Beta 58A	4
	Shure Beta 91	1
	Shure Beta 98	2
	Shure SM57	4
	Shure SM58	4
	Shure SM58S	2
<b>Wireless</b>	Sennheiser EM3732 UHF wireless mic system	10 sets
<b>Microphone</b>	Handheld: SKM5200-II <b>OR</b>	10
	Bodypack: SK5212-II	10
	<b>Max. 10 units with a minimum booking of 2 sessions (Incur extra charge)</b>	
<b>Stage Monitor</b>	Altec DTS-99 Foldback speakers (fix mounted)	2
	L-Acoustics X12	6
	L-Acoustics X8	6
	L-Acoustics 112P	4
<b>CD Player</b>	Denon DN-C635 CD player	2
	Tascam SS-CDR250N CD Media player	2
<b>Multimedia Projector</b>	Panasonic PT-DZ21K (20,000 lm)	1
	Panasonic PT-RQ35K (32,000 lm)	2
<b>Lens</b>	ET-D75LE10	2
	ET-D75LE20	1
	ET-D3LEU100	2
<b>Video Streaming System</b>		
Camera	Panasonic AW-UE150K	4
Remote Camera	Panasonic AW-RP150	2
Controller		
Video Switcher	BMD ATEM 4 M/E Broadcast Studio 4K	1
	BMD ATEM 1 M/E Advanced Panel	1
Video Recorder	BMD HyperDeck Studio 4K Pro	8
	BMD Duplicator 4K	2
<b>LED Surtitle Display Board</b>	Computerised Surtitle System (Two panels will be located horizontally on the left and right sides of the apron.)	
<i>Horizontal board (2pcs)</i>	– <u>English or Chinese Text</u>	
	– 2000 x 750 mm (W x H)	
	– System displays 4 lines per page.	
	<i>Surtitle input and stored in Microsoft® Chinese word <u>text file</u> format.</i>	
	<i>Control panels set inside Projection Room at Stalls level.</i>	
<b><u>COMMUNICATION</u></b>		
Stage manager control panel at stage left		
Two channels intercom system for stage, lighting and sound		
Cue light system		
Paging and show relay system		
Close Circuit TV system		
Production desk can be set at the middle of the stall upon request		
<b>Prior to booking date, please confirm with Resident Technical Manager for the availability of the equipment.</b>		
<b>All required equipment will be set-up during the booking sessions; please allow adequate time for equipment set-up before performance or rehearsal</b>		