



Kwai Tsing Theatre - Black Box Theatre

FULL Technical Information

V. 2023.10.03

Page 1 of 5

Performing Arts Division - Technical Support Unit

Kwai Tsing Theatre
12 Hing Ning Road
Kwai Chung,
NT, HK
Phone
852-2408 0128
Fax
852-2944 8743

CONTACTS

Sharon CHOW
Senior Manager (NTS)
Venue
Direct Line
852-2408 0660

Rei WONG
Manager (KTT)
Operations
Direct Line
852-2408 2115
Email
rlfwong@lcsd.gov.hk

Eric CHAN
Resident Technical
Manager (NTS)
Direct Line
852-2406 2848
Email
eytchan@lcsd.gov.hk

GENERAL SET-UP

Black Box Theatre operates on a 'bare-walls' touring policy. That is, all equipment is normally set-up and struck within the booking period. Hirers are reminded to allow sufficient preparation time to hang theatre masking, rig all overhead stage lighting and set up sound. Check with our Resident Technical Manager for any other equipment and technical enquiry.



The Black Box Theatre is designed with variable seating formats for transverse, thrust or arena stage set-up. Seating capacities range from 130 to 160 according to the chosen format. It is most suitable for small-scale and experimental productions.

DIRECTIONS

MTR:
Tsuen Wan Line, Kwai Fong Station, Exit C

Driving Route (From S to N):
Route 3 → Exit 4B → Hing Fong Road → Kwai Fuk Road → Hing Ning Road

Driving Route (From NW to S):
Route 3 → Exit 10 → Hing Fong Road → Kwai Fuk Road → Kwai Yan Road → Hing Ning Road



LOADING

Clearance of truck: 3.6m

Dock Height: 0.485m
Door Dimension:
1.45 x 1.95m (W x H)

Lift dimension:
2.15 x 2.10 x 2.20m
(W x D x H)

STAGE ENTRANCE

Same entrance as audience,
from Venue Foyer 1st floor

PARKING

Permit required



Note: Except for buses and those with permits issued by the Commissioner for Transport, vehicles exceeding 11 metres are not allowed into Hing Ning Road.

(https://www.td.gov.hk/en/traffic_notices/index_id_22410.html)



AUDITORIUM



Total Seating:

Transverse Stage: 130 seats

Thrust Stage: 150 seats

Arena Stage: 160 seats

Hall Size (Without Seating)

Width: 13.82m

Depth: 14.45m

Area: 199.70m²

TRANSVERSE STAGE (seating on opposite side of the stage area)

Width

7.30m

Depth

11.30m

Area

82.49m²

THRUST STAGE (seating on three sides, surrounding the stage area)

Width

7.30m

Depth

9.45m

Area

68.99m²

ARENA STAGE (seating on four sides of the stage)

Width

7.30m

Depth

8.93m

Area

65.19m²

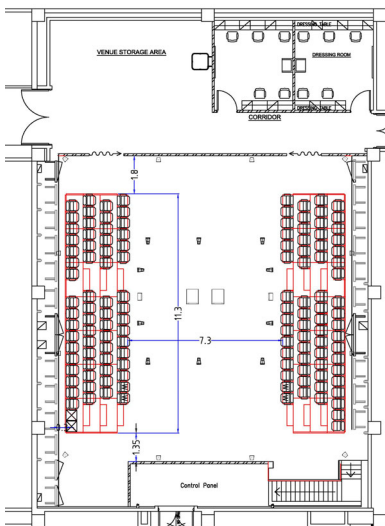

Transverse stage

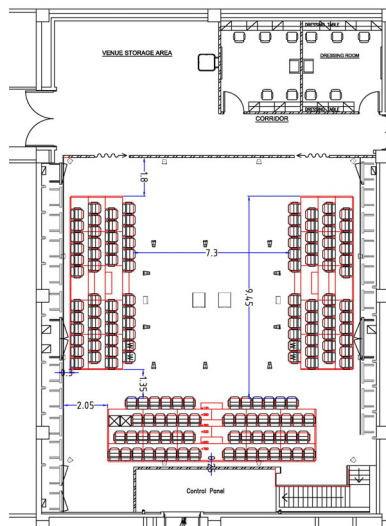

Thrust stage

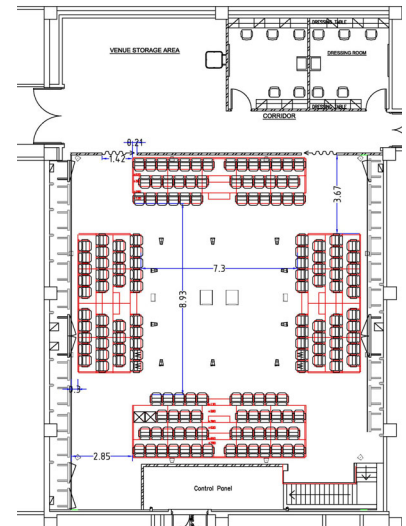

Arena stage



STAGE HEIGHT

Clearance under lighting truss

5.34m

STAGE FLOOR

Flat black Sprung Floor surface (Harlequin Vitality Pro)

600kg/m² SWL

SIDE STAGE

Not available

REAR STAGE

Not available

STORAGE SPACE

Next to dressing rooms and Store Room

CROSSOVER

Back of the stage corridor

RIGGING

Lighting truss

Length	10.50m	5
Diameter	48mm	
Truss distance	Free sliding along the long side of the theatre	
Capacity	250kg SWL	
Socket outlets (on each truss)	12	

I-beam height from stage floor

6.40m

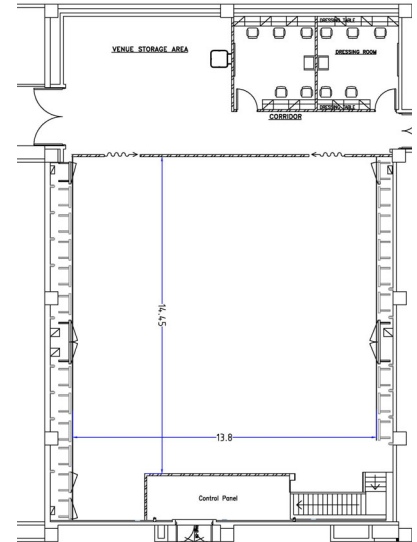

STAGE EQUIPMENT

Auditorium Seating Platform and Chair

Platform	1.60 x 0.80 x 0.26m (W x D x H)	Total 50 pcs
	1.60 x 0.80 x 0.52m (W x D x H)	
	1.60 x 0.80 x 0.78m (W x D x H)	

Chairs 160 pcs (maximum)

Dancing Tile 4 rolls
for dance show only

2 x 10m (W x L) (Black)
(Please allow time to lay the tiles during booking time)

Instrument
 Upright Piano 1

DRESSING ROOM

No. A & B: each accommodate 5 persons

Dressing room fitted with lockers

Irons & boards and steamers can be loaned from Resident Stage Management

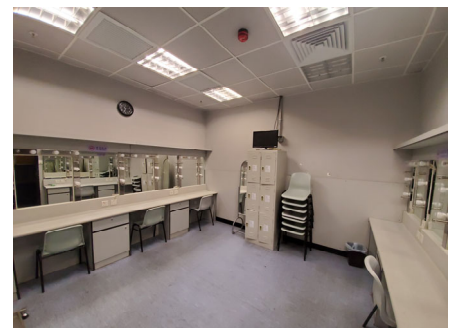



LIGHTING

Dimmer	96 nos. of 3kW				
Control Board	ETC Gio@5, with full backup control facilities, controllable of maximum 4,096 parameters, located in control booth at rear of auditorium.				
Houselight	Dimmer controlled at control booth.				
Circuit	96 x 3kW production lighting circuits, hard patching wiring type, 3kW circuits are terminated to 15A socket outlets to UK standard respectively on the production lighting boxes, distributed at various locations throughout the stage and lighting trusses.				
Additional Power	380 Volt / 3-phase, c/w 32A 5-pin socket for temporary cable connection. Connection must be conducted by a local registered electrical worker. Hirer shall supply adequate circuit protective devices for all bring in electrical installation. 13A wall-mounted socket outlets at UK standard are provided on the stage.				
Profile	750W	ETC	Source 4 25/50°	20	
	750W	ETC	Source 4 15/30°	20	
Fresnel	650W	Selecon	Acclaim	20	
	1.2kW	Strand	Cantata PC	20	
	2.0kW	Strand	Alto F	6	
LED Beam Wash	280W	Chauvet	Rogue R1	20	
PAR	1kW	Strand	PAR	10	CP60, CP61 & CP62 lamps, 10 pcs each available
Beamlight	500W	Strand	Beamlite 500	2	4kW Dimmer 'Dynalite'
Smoke Generator		Look Solutions	Viper NT (DMX controllable)	1	
Strobe Light		Martin	Atomic 3000 LED (DMX controllable)	1	
UV light		Wildfire		1	
Others	Side light tower			6	
	Equipment setup:	4 (top)	ETC Source 4 15/30°	1880mm	
		3	ETC Source 4 15/30°	1440mm	
		2	ETC Source 4 15/30°	1020mm	
		1 (bottom)	(without equipment)	580mm	
Iris & Gobo Holder		<u>Iris</u>	<u>Holder</u>	<u>Holder</u>	<u>Gobo</u>
Spotlight Applicable		<u>Qty.</u>	<u>Qty.</u>	<u>Type</u>	<u>Size</u>
	ETC Source 4	12	12	A	100mm
					75mm

*** General stage lighting is not available**

Hirers are required to submit their own lighting design.*

Supply of above equipment subject to availability on receipt of a lighting plan.

Equipment availability does vary slightly according to equipment conditions and maintenance. Check with Technical Manager for any updates.

Hirer will be provided with basic lighting only, from available hung equipment, if technical preparation time is less than 2 hours in the booking.

All brought-in "Electrical and Stage Lighting Equipment" to be used in LCSD PA venues, shall meet the requirements of "Code of Practice for Electricity (Wiring) Regulations (2020 Edition)". Please contact the venue management for any electrical safety concern. Website reference:

https://www.emsd.gov.hk/en/electricity_safety/index.html



SOUND

Sound System	d&b audiotechnik Soundscape Immersive System	
	d&b audiotechnik Ti10P Main Speaker	10
	d&b audiotechnik 18S-SUB Subwoofer	2
	d&b audiotechnik 8S Effect Speaker	12
Additional Speaker	d&b audiotechnik Y10P	2
	d&b audiotechnik Y-SUB	2
Main Control Console	Soundcraft Vi 1000 mixing console:	
	Mono inputs	32
	Outputs	8
	Auxiliary outputs	6
	Stereo outputs	1
Microphone tie line	at up stage left	12
	at up stage right	12
Microphone	Shure Beta 58	4
Wireless Microphone	Sennheiser UHF SKM 500 G3 hand-held type	4
	Sennheiser UHF SK 500 G3 body-pack type	4
	Max. 4 units (Incur extra charge)	
CD Player	Denon DN-C635	2
Multimedia Projector	Panasonic PT-RZ970 (10,000 Lumens), fix installed at control booth	1
	Panasonic PT-RZ120 (12,000 Lumens)	2
Video Streaming System		
Camera	Panasonic AW-UE150K	4
Remote Camera Controller	Panasonic AW-RP150	2
Video Switcher	BMD ATEM 4 M/E Broadcast Studio 4K	1
	BMD ATEM 1 M/E Advanced Panel	1
Media Recorder	BMD HyperDeck Studio 4K Pro	8
	BMD Duplicator 4K	2

COMMUNICATION

Stage manager control panel at control booth
 Intercom system for stage, lighting and sound
 Show relay system
 Close Circuit TV system

Prior to booking date, please confirm with Resident Technical Manager for the availability of the equipment.
All required equipment will be set-up during the booking sessions; please allow adequate time for equipment set-up before performance or rehearsal